



Receptacle Selection Guide

Mounting Style	Image	Panel Thread Types	Page
Front Mount		<u>M8</u>	<u>C17</u>
Rear Mount		<u>M8</u> <u>7/16-20 with Solder Cups</u>	<u>C18</u> <u>C22</u>
PCB Mount		<u>M8 with PCB Pins</u> <u>7/16-20 with Header Pins</u> <u>M8 with Header Pins</u>	<u>C19</u> <u>C19</u> <u>C20</u>

We reserve the right to make technical alterations without prior notice.

3, 4 and 6-Wire Receptacles, Front Mount

- NEMA 1, 3, 4, 6P
- IEC IP67 Protection



Receptacles

Housing Style	Female Part Number	Male Part Number	Features	Pinout
<p>MFKS ..</p>	MFKS 3-*		3x24 AWG, 105 °C, 125 V, 4 A, mates with 3-pin threaded female cordsets	<p>Female</p> <p>1. BN 3. BU 4. BK</p> <p>Male</p>
		MFS 3-*	3x24 AWG, 105 °C, 125 V, 4 A, mates with 3-pin snap lock female cordsets	<p>Male</p>
	MFKS 4-*		4x24 AWG, 105 °C, 125 V, 4 A, mates with 4-pin threaded female cordsets	<p>Female</p> <p>1. BN 2. WH 3. BU 4. BK</p> <p>Male</p>
		MFS 4-*	4x24 AWG, 105 °C, 125 V, 4 A, mates with 4-pin snap lock female cordsets	<p>Male</p>
	<p>MFS ..</p>	MFKS 6-*	6x24 AWG, 105 °C, 125 V, 2 A, mates with 6-pin threaded female cordsets	<p>Female</p> <p>1. BN 2. WH 3. BU 4. BK 5. GY 6. PK</p> <p>Male</p>
		MFS 6-*	6x24 AWG, 105 °C, 125 V, 2 A, mates with 6-pin snap lock female cordsets	<p>Male</p>

* Length in meters. Standard lead length is 0.2 meters. Consult factory for other lengths.
Standard housing material is nickel plated brass .. "MFK(S).." ; "MFK(S)V.." indicates stainless steel.

3, 4 and 6-Wire Receptacles, Rear Mount

- NEMA 1, 3, 4, 6P
- IEC IP67 Protection



Housing Style	Male Part Number	Features	Pinout
<div><p>MFS ..F..</p><p>Typical panel cutout is 8.2 mm</p></div> <div><p>MFSS ..</p><p>Typical panel cutout is 8.2 x 7.1 mm</p></div>	MFS 3F-*	3x24 AWG, 105 °C, 125 V, 4 A, mates with 3-pin snap lock or threaded female cordsets, rear mount	<div><div>1. BN 3. BU 4. BK</div><div><p>Male</p></div></div>
	MFS 4F-*	4x24 AWG, 105 °C, 125 V, 4 A, mates with 4-pin snap lock or threaded female cordsets, rear mount	<div><div>1. BN 2. WH 3. BU 4. BK</div><div><p>Male</p></div></div>
	MFS 6F-*	6x24 AWG, 105 °C, 125 V, 2 A, mates with 6-pin snap lock or threaded female cordsets, rear mount	<div><div>1. BN 2. WH 3. BU 4. BK 5. GY 6. PK</div><div><p>Male</p></div></div>
	MFSS 3-*	3x24 AWG, 105 °C, 125 V, 4 A, mates with 3-pin snap lock or threaded female cordsets, front mount	<div><div>1. BN 3. BU 4. BK</div><div><p>Male</p></div></div>
	MFSS 4-*	4x24 AWG, 105 °C, 125 V, 4 A, mates with 4-pin snap lock or threaded female cordsets, front mount	<div><div>1. BN 2. WH 3. BU 4. BK</div><div><p>Male</p></div></div>
	MFSS 6-*	4x24 AWG, 105 °C, 125 V, 4 A, mates with 4-pin snap lock or threaded female cordsets, front mount	<div><div>1. BN 2. WH 3. BU 4. BK 5. GY 6. PK</div><div><p>Male</p></div></div>

We reserve the right to make technical alterations without prior notice.

* Length in meters. Standard lead length is 0.2 meters. Consult factory for other lengths.
Standard housing material is nickel plated brass .. "MFS(S).." ; "MFS(S)V.." indicates stainless steel.

3, 4 and 6-Pin Receptacles with PCB Pins

- NEMA 1, 3, 4, 6P
- IEC IP67 Protection



Housing Style	Female Part Number	Features	Pinout
<p>MFKS .. F-PCBF</p> <p>WMFK .. F-PCBF</p>	MFKS 3F-PCBF	PCB Pins, 85 °C, 60 V, 4 A, mates with 3-pin threaded male cordsets	Female
	MFKS 4F-PCBF	PCB Pins, 85 °C, 30 V, 4 A, mates with 4-pin threaded male cordsets	Female
	WMFK 3F-PCB	PCB Pins, 80 °C, 60 VAC/75 VDC, 4 A, mates with 3-pin threaded male cordsets	Female
	WMFK 4F-PCB	PCB Pins, 80 °C, 30 VAC/36 VDC, 4 A, mates with 4-pin threaded male cordsets	Female
	WMFK 6F-PCB	PCB Pins, 80 °C, 24 VDC, 1 A, mates with 6-pin threaded male cordsets	Female

Standard housing material is nickel plated brass.

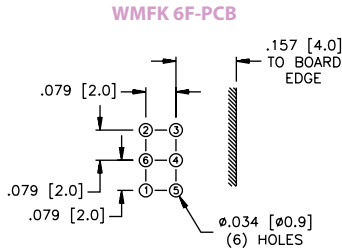
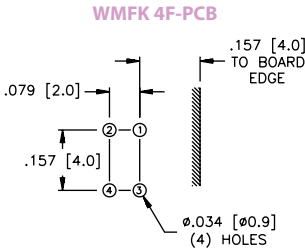
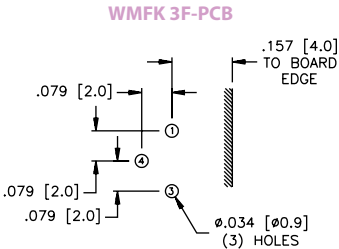
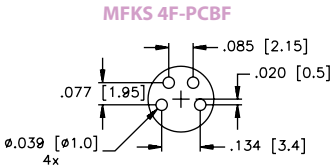
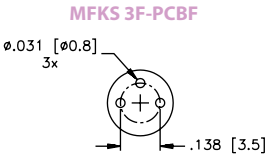

- NEMA 1, 3, 4, 6P
- IEC IP67 Protection



Housing Style	Male Part Number	Features	Pinout
 	WMFS 3-PCB	PCB Pins, 80 °C, 60 VAC/75 VDC, 4 A, mates with 3-pin snap lock or threaded female cordsets	Male
	WMFS 4-PCB	PCB Pins, 80 °C, 30 VAC/36 VDC, 4 A, mates with 4-pin snap lock or threaded female cordsets	Male
	WMFS 6-PCB	PCB Pins, 80 °C, 24 VDC, 1 A, mates with 6-pin snap lock or threaded female cordsets	Male
	WMFS 3F-PCB	PCB Pins, 80 °C, 75 VDC, 4 A, mates with 3-pin snap lock or threaded female cordsets	Male
	WMFS 4F-PCB	PCB Pins, 80 °C, 36 VDC, 4 A, mates with 4-pin snap lock or threaded female cordsets	Male
	WMFS 6F-PCB	PCB Pins, 80 °C, 24 VDC, 1 A, mates with 6-pin snap lock or threaded female cordsets	Male

We reserve the right to make technical alterations without prior notice.

Standard housing material is nickel plated brass.

WMFS 3-PCB

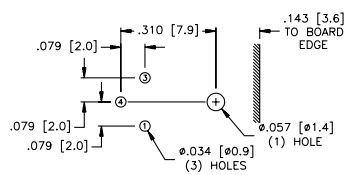

WMFS 4-PCB

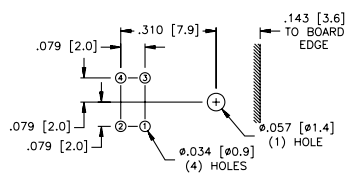

WMFS 6-PCB

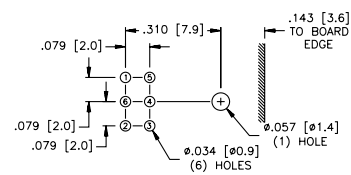

WMFS 3F-PCB

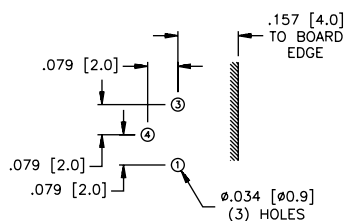

WMFS 4F-PCB

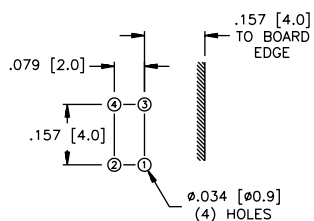

WMFS 6F-PCB

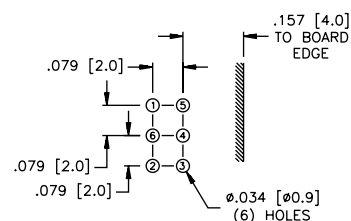

3 and 4-Pin Receptacles with PCB Pins and Mounting Bracket

- IEC IP67 Protection



Housing Style	Female Part Number	Features	Pinout
<p>MFKSH .. F-PCB</p>	MFKSH 3F-PCB	PCB Pins, 85 °C, 60 V, 4 A, mates with 3-pin threaded male cordsets	Female
MFKSH 4F-PCB	PCB Pins, 85 °C, 30 V, 4 A, mates with 4-pin threaded male cordsets	Female 	
<p>MFKSHL .. F-PCB</p>	MFKSHL 3F-PCB	PCB Pins, Long Bracket, 85 °C, 60 V, 4 A, mates with 3-pin threaded male cordsets	Female
MFKSHL 4F-PCB	PCB Pins, Long Bracket, 85 °C, 30 V, 4 A, mates with 4-pin threaded male cordsets	Female 	
<p>WMFKSH .. F-PCB</p>	WMFKSH 3F-PCB	PCB Pins, 85 °C, 60 V, 4 A, mates with 3-pin threaded male cordsets	Female
WMFKSH 4F-PCB	PCB Pins, 85 °C, 30 V, 4 A, mates with 4-pin threaded male cordsets	Female 	

Standard housing material is nickel plated brass.

MFKSH 3F-PCB
MFKSHL 3F-PCB

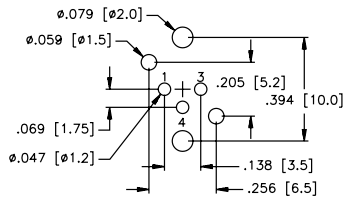

WMFKSH 3F-PCB

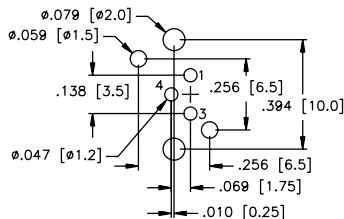

MFKSH 4F-PCB
MFKSHL 4F-PCB

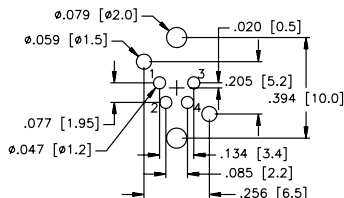

WMFKSH 4F-PCB

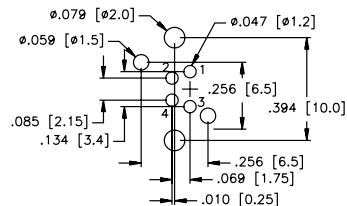

3, 4 and 6-Pin Receptacles, Rear Mount with Solder Cups

- NEMA 1, 3, 4, 6P
- IEC IP67 Protection



Housing Style	Female Part Number	Features	Pinout
	MFKS 3F	Solder Cups, accepts up to 22 AWG conductors, 80 °C, 125 V, 4 A, mates with 3-pin threaded male cordsets	Female
	MFKS 4F	Solder Cups, accepts up to 22 AWG conductors, 80 °C, 125 V, 2 A, mates with 4-pin threaded male cordsets	Female
	MFKS 6F	Solder Cups, accepts up to 24 AWG conductors, 80 °C, 125 V, 2 A, mates with 6-pin threaded male cordsets	Female

Standard housing material is nickel plated brass.

We reserve the right to make technical alterations without prior notice.

3, 4 and 6-Pin Feed-Thru Receptacles

- Female to Male Receptacles
- NEMA 1, 3, 4, 6P
- IEC IP67 Protection



Housing Style	Part Number	Features	Pinout
<p>MFSV MFKV ..</p>	MFSV MFKV 3/M8	3-conductor, 80 °C, 125 V, 4 A, mates with 3-pin threaded cordsets	<div><div>Female</div></div> <div><div>Male</div></div>
<p>MFSV MFKV ..</p>	MFSV MFKV 4/M8	4-conductor, 80 °C, 125 V, 2 A, mates with 4-pin threaded cordsets	<div><div>Female</div></div> <div><div>Male</div></div>
<p>MFSV MFKV ..</p>	MFSV MFKV 6/M8	6-conductor, 80 °C, 125 V, 2 A, mates with 6-pin threaded cordsets	<div><div>Female</div></div> <div><div>Male</div></div>

Standard housing material is nickel plated brass.

We reserve the right to make technical alterations without prior notice.

Receptacles